

HMEIPMTG - SERIES

BUL86351

REV. B

ASSEMBLY INSTRUCTIONS FOR HME INNER PANEL MOUNTING HARDWARE

A) Install bottom inner panel brackets (item 3 and 4) to inner panel in the orientation shown. Use 3/8-16 x 1.25" Screw (item 8) and a flat washer (item 9) to secure brackets to inner panel.

B) Install top brackets (item 1 and 2) to HME top strut, see BUL86265.

C) Inner panel installation procedure see BUL86265

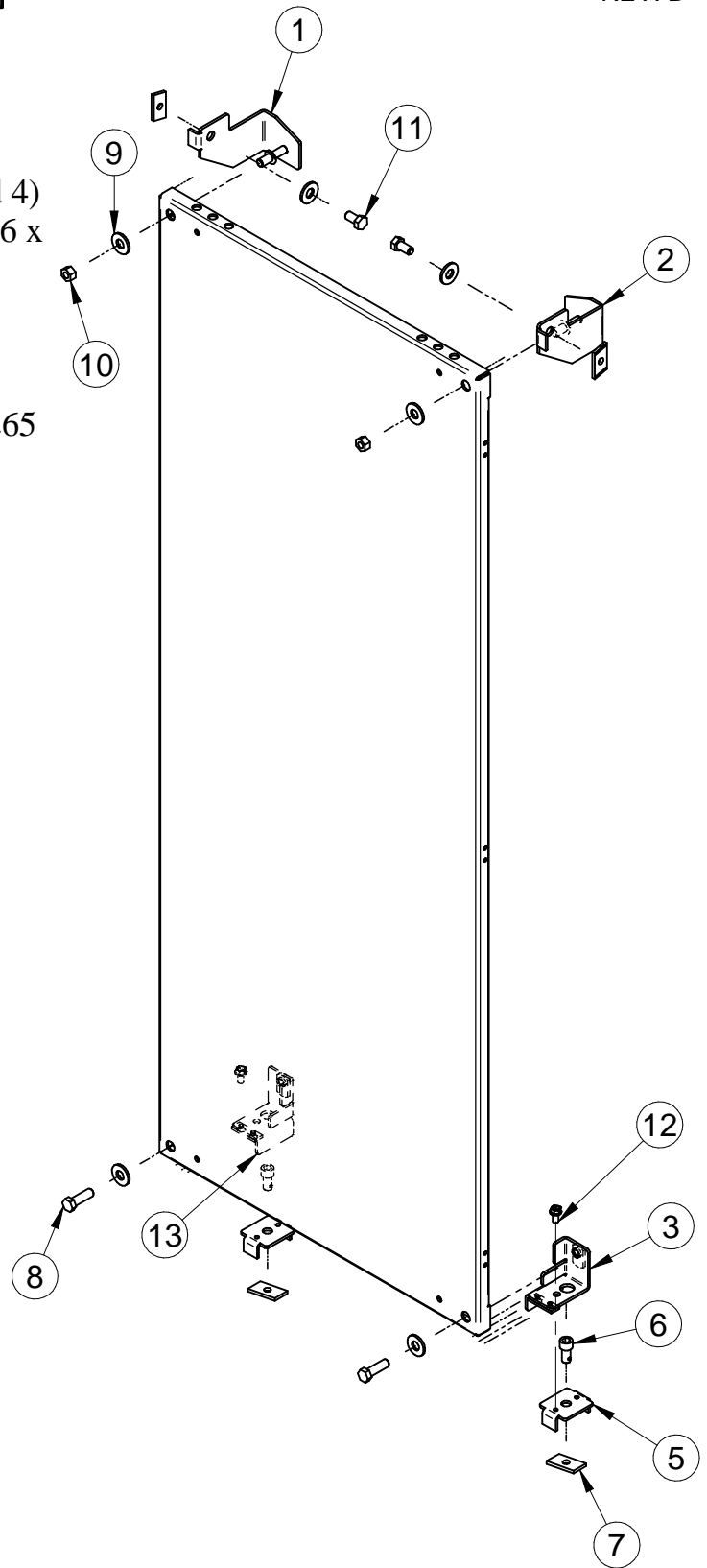

ITEM	DESCRIPTION	QTY
1	HME - TOP LEFT INNER PANEL BRACKET ASSY	1
2	HME - TOP RIGHT INNER PANEL BRACKET ASSY	1
3	HME - BOTTOM RIGHT INNER PANEL BRACKET	1
4	HME - BOTTOM LEFT INNER PANEL BRACKET	1
5	HME - INNER PANEL STOP BRACKET	2
6	3/8-16 Cap Screw	2
7	3/8-16 Spring Nut	4
8	3/8-16 x 1.25" Screw	2
9	Flat Washer	6
10	3/8-16 Nut	2
11	3/8-16 x 0.75" Screw	2
12	SCC17994 - 1/4-20x1/2" HEX SLOT BOLT	2
	BUL86265	1

TOOL BOX



9/16" Socket
Wrench



**HAMMOND
MANUFACTURING™**
www.hammondmfg.com